

**Assembly Condition**

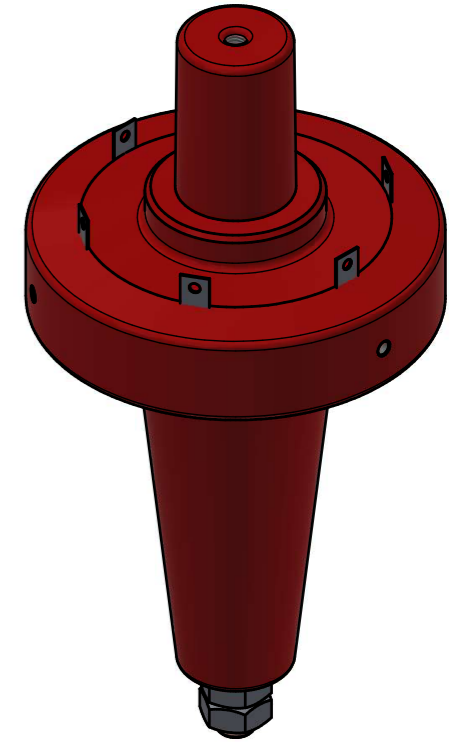
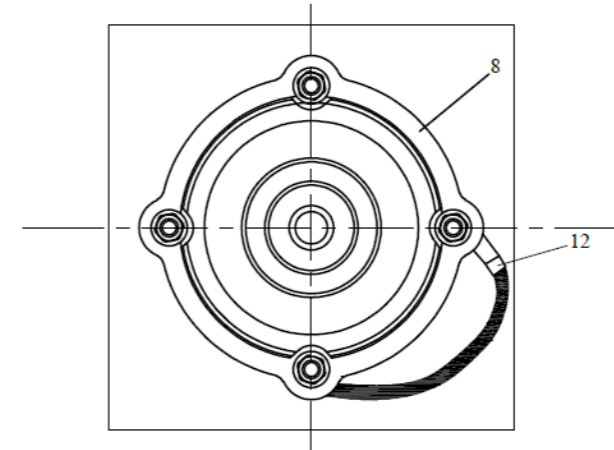

14	1	Brass Washer Ø11			
13	4	Aluminium Press Bit - DIN 42538			
12	1	Earthing Cable			
11	4	Steel Washer Ø10.5			
10	4	Fixing Nuts - M10 - Steel			
9	4	M10*58 Fixing Stud Screw - S. Steel			
8	1	Fixing Ring - S. Steel DIN 42538			
7	1	Transformer Cover			
6	1	NBR Gasket			
5	2	Brass Nut - M10			
4	1	Bushing Copper - M10			
3	6	Fixing Shoe - S. Steel			
2	1	Bushing Interface Part-A			
1	1	Plastic Protective Cover			
ITEM	QTY	DESCRIPTION	REMARKS	RATED CURRENT A	250

Short Circuit Rating		
RMS Symm (kA)	1 sec	6.3
	2 sec	4.5
	3 sec	3.6
PEAK Symm (kA)		15.8

BUSHING TYPE	24 250 N
TYPE OF CONTACT	SLIDING DIA 14
RATED VOLTAGE kV	24
BIL kV 1.2 X 50 µs	125
P.F. WITHSTAND VOLTAGE 60 s kV (r.m.s value)	55
PARTIAL DISCHARGE EXTINCTION (5pC) kV	21
RATED CURRENT A	250

03					
02					
01					
00	10/04/23	RV	MA	MA	Original
Rev	Date	Drw	Chk	App	Description
General Tolerance Machining : ISO 2768 - Medium Fabrication : ISO 13920 - Class B			Surface Texture : ISO 1302		All dimension in millimetres unless otherwise stated
<b>IF IN DOUBT - PLEASE ASK !</b>					
			Title		
			Plug In Bushing 24kV/250A EN50180		
Metson Power Çamlıca Mah. Anadolu Bulv. Timco İşyerleri B Blok No:6 06200 Yenimahalle, Ankara TURKEY			Description		Scale
			Plug In Bushing 24kV/250A - 224MM		1 : 1.5
Drawing No.			Sheet No.		Total Sheet
			ID_B01100A		1
Size			Total Sheet		Size
			1		1